

## LED Green Exit and Emergency Combo



### Single or Double Face in One Unit

Topaz's line of emergency exit and lighting combo units offer safety and security in an easy to install design. Emergency units are OSHA compliant and contain long lasting Ni-Cad battery backup for essential illumination during a power outage.

### FEATURES

- 120/277V dual voltage operation
- Green EXIT letters and two fully adjustable LED lamp heads
- High-impact, 5VA flame retardant thermoplastic ABS housing
- Ceiling, wall, or side mounting capability (canopy included)
- Test switch and AC supply indicator
- Removeable knockout chevron directional arrows
- Battery backup with accessible test button for 90 minutes of illumination during a power outage
- Suitable for damp locations
- Meets NFPA 70, NFPA 101, UL924, NEC and OSHA standards

### APPLICATIONS

- Emergency lighting for office, industrial, retail and other public spaces





Job Name/Title: \_\_\_\_\_ Catalog Number \_\_\_\_\_  
 Contractor: \_\_\_\_\_ Notes: \_\_\_\_\_

## LED Green Exit and Emergency Combo

### GENERAL SPECIFICATIONS

**Input Voltage:** 120/277V (dual voltage)  
**Frequency:** 50/60 Hz  
**CRI:** N/A  
**Dimmability:** No  
**Avg. Rated Life:** 500 uses  
**Wet / Damp / Dry Location:** Damp  
**Construction:** Thermoplastic  
**Recharge time:** 24 hrs  
**Runtime:** >/= 90 minutes  
**Unit Weight:** 4.05 lbs  
**Battery Backup:** Ni-Cad 3.6V 1,200mA  
**Ambient Operating Temperature:** 50°F to 104°F  
**Energy Used in Maintenance Mode:** 3.5W

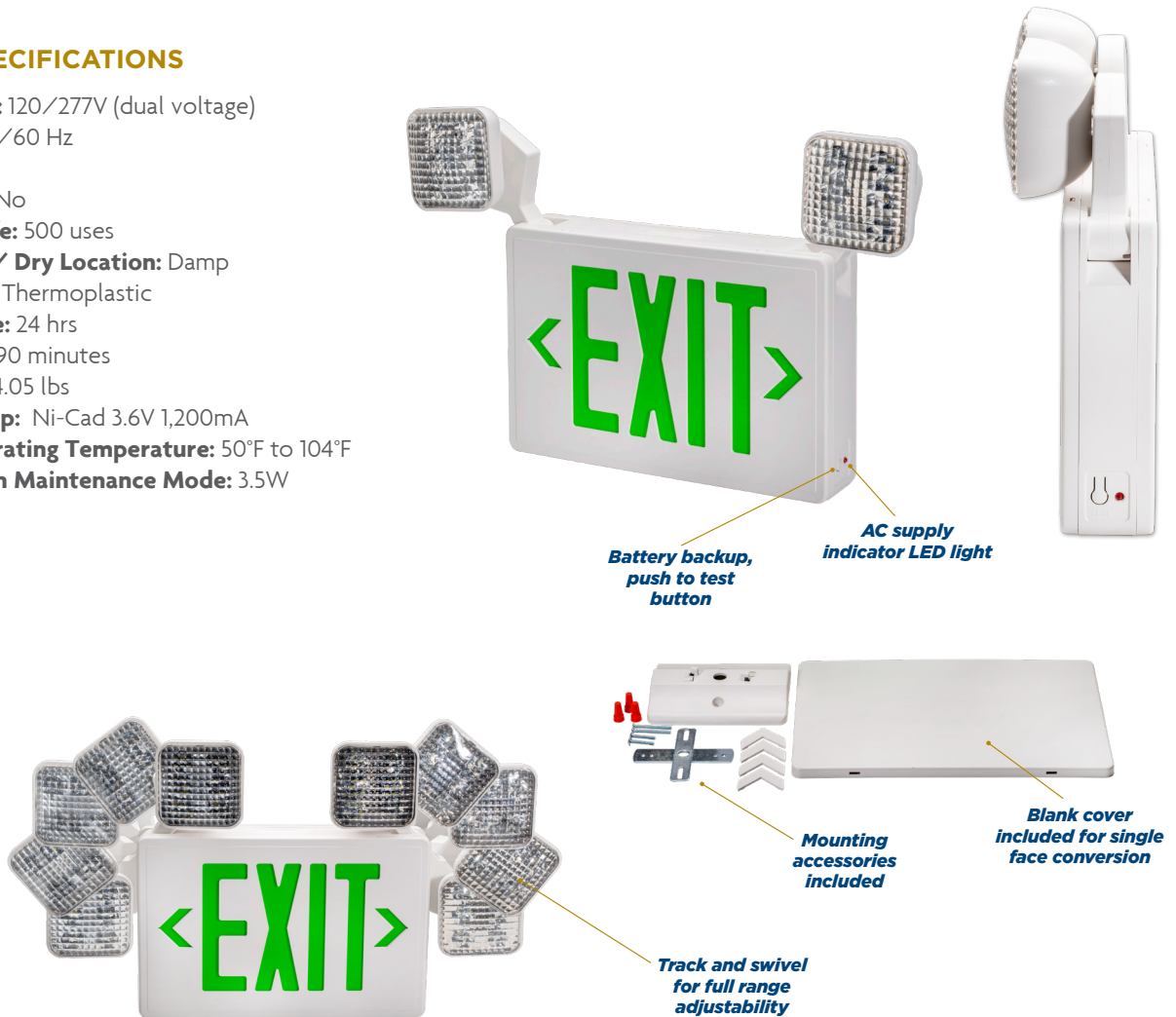

### SPECIFICATIONS / ORDER INFO

Catalog Number	Order Code	UPC	Mounting	Watts	Lumens	Lumens Per Watt	Dimensions	Pk-Qty
ESC/LED/GW	75141	751338034662	Wall, side or ceiling	1 watt per head	100 per head	100	13" x 2.4" x 8.3"	4-PK

### NOMENCLATURE

**Example: ESC/LED/GW**  
**ESC=Exit Sign and Emergency Combo / LED=LED / GW=Green Letters, White Housing**

©2019 Topaz Lighting Corp.

This device complies with Part 15 of the FCC Rules. Operation is subject to the following two conditions: (1) this device may not cause harmful interference, and (2) this device must accept any interference received, including interference that may cause undesired operation. Fixture may not be compatible with all dimmers. Visit [www.topaz-usa.com](http://www.topaz-usa.com) for up-to-date dimmer compatibility information. Specifications subject to change without notice.