

APOLLO LED HIGH BAY

SL923HBF INSTALLATION INSTRUCTIONS

SAFETY WARNING READ CAREFULLY



• Be certain electrical power is OFF before and during installation and maintenance.

• Risk of fire or electric shock. Installation requires knowledge of electrical systems. For install by qualified electrician only. Do not attempt installation if not qualified.

• To prevent wiring damage or abrasion, do not expose wiring to edges of sheet metal or other sharp objects.

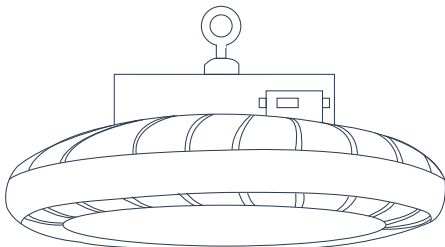

INSTRUCTIONS

1. Turn off electrical power before attempting installation.

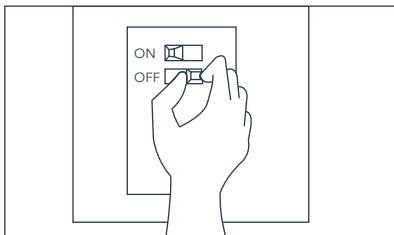

2. Screw in I-hook into fixture. Tighten locking bolt to secure I-hook.

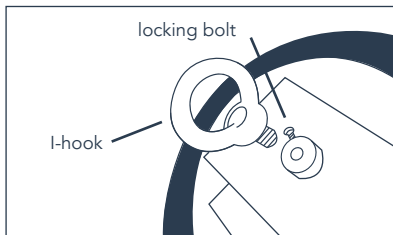

3. Attach luminaire to hanging chain (not included). Mount hanging chain.

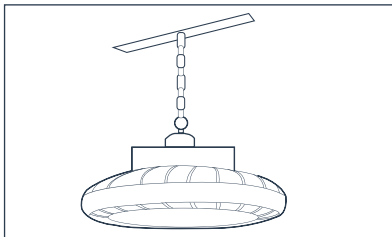

4. Attach safety carabiner.

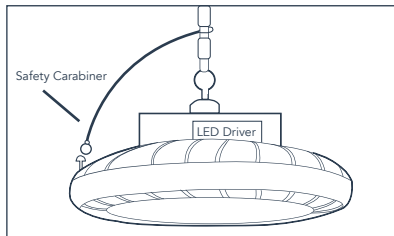

5. To access dimming wiring, open dimming access box.

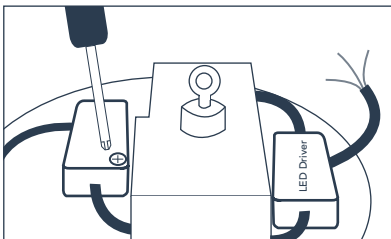

6. Wire high bay with diagrams shown below.

Supply Line (Black)



Supply Neutral (White)



Supply Grounding (Green)



Line (Black)



- A. If 0/1-10 dimming is used, connect the violet lead to the supply positive dimming lead.
- B. If 0/1-10V dimming is used, connect the grey lead to the supply negative dimming lead.
- C. If 10V aux output is used, connect the white/black lead to the device accordingly.