

Items:
F-WPC/15W/CTS/BZ-96 F-WPC/15W/CTS/WH-96
F-WPC/20W/CTS/BZ-96 F-WPC/20W/CTS/WH-96
F-WPC/30W/CTS/BZ-96 F-WPC/30W/CTS/WH-96



INSTALLATION INSTRUCTIONS

Read instructions carefully before installing. Keep these instructions for future reference. Topaz fixtures must be wired in accordance with the National Electrical Code and all applicable local codes. Proper grounding is required for safety. THIS PRODUCT MUST BE INSTALLED IN ACCORDANCE WITH THE APPLICABLE INSTALLATION CODES BY A QUALIFIED ELECTRICIAN WHO IS FAMILIAR WITH THE CONSTRUCTION AND OPERATION OF THE PRODUCT AND THE HAZARDS INVOLVED.



Warnings to avoid risk of electrical shock

- Make certain electrical supply is OFF before energizing fixture.
- Make all electrical and grounded connections in accordance with local codes or the National Electrical Code. Failure to do so may result in serious personal injury.
- All wiring connections must be done by a qualified electrician and should be capped with UL approved connectors.
- To avoid risk of burn be sure fixture temperature is cool enough to touch before handling.
- While the light is on, please avoid direct eye exposure.
- Combustible materials should be kept away from fixture/lens.

1. Disconnect electricity at fuse or circuit breaker box.
2. Remove parts pack and fixture components in order to make sure that all parts are included (3pcs Close-End connectors, 1pcs EVA cotton pad).
3. Loosen the 4 captive screws and remove the back housing.

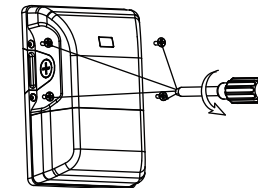

4. Select the desired CCT.

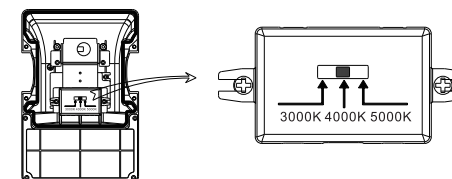

INSTALLATION INSTRUCTIONS

5. Remove knockout from both the back of the housing and gasket. Peel off yellow white protective paper in order to expose adhesive.

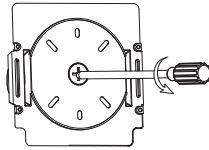

6. Align the circular gasket with the indentation of the back of the housing. Once aligned, press to adhere.

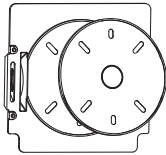

7. Pull power supply wires through the back of the housing and secure back of housing to junction box.

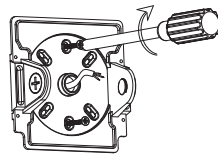

8. Make supply connections to the fixture's ground, black and white wire using the wiring diagram on page 3.

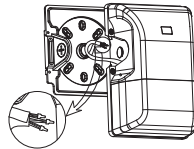

9. Energize the luminaire to verify operation.

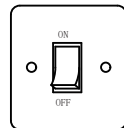

10. Secure the reflector to the back of the housing by tightening screws on all 4 sides.

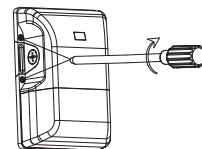

INSTALLATION INSTRUCTIONS

Items:

F-WPC/15W/CTS/BZ-96

F-WPC/15W/CTS/WH-96

F-WPC/20W/CTS/BZ-96

F-WPC/20W/CTS/WH-96

F-WPC/30W/CTS/BZ-96

F-WPC/30W/CTS/WH-96

Hot

LED Driver

LINE
(Black Wire)

Neutral

NEUTRAL
(White Wire)

**120
VOLTS**

Ground

GROUND

Hot1

LED Driver

LINE
(Black Wire)

Neutral

GROUND

**208
VOLTS**
208V Split Phase
Wiring (USA 3 Wire)

Hot2

NEUTRAL
(White Wire)

Hot1

LED Driver

LINE
(Black Wire)

Neutral

GROUND

**240
VOLTS**
240VAC Split Phase
Wiring (USA 3 Wire)

Hot 2

NEUTRAL
(White Wire)

Hot

LED Driver

LINE
(Black Wire)

Neutral

NEUTRAL
(White Wire)

**277
VOLTS**

Ground

GROUND