

CASCADE LED Wallpack

SL923WMK INSTALLATION INSTRUCTIONS



SAFETY WARNING READ CAREFULLY



- Be certain electrical power is OFF before and during installation and maintenance.
- Risk of fire or electric shock. Installation requires knowledge of electrical systems. For install by qualified electrician only. Do not attempt installation if not qualified.
- To prevent wiring damage or abrasion, do not expose wiring to edges of sheet metal or other sharp objects.

Model Diagram

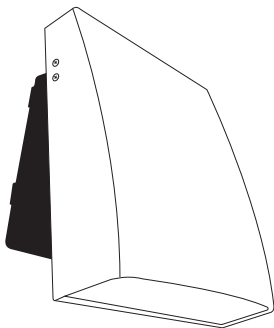

INSTRUCTIONS

1. Open the fixture to 90 degrees. Loosen the 2 screws and take off the back plate.

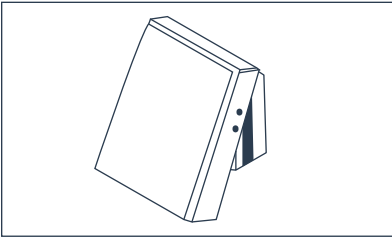

2. Clean the mounting area of dust and debris. Secure the back plate to junction box by screws, apply silicone sealant between the back plate and mounting surface, attention the UP direction. See below.

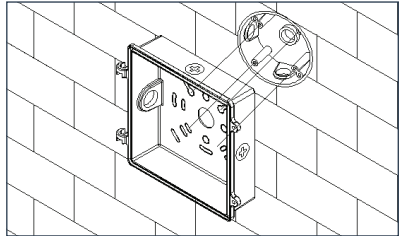

3. Hang the fixture on the back plate. Connect wires to wiring terminal; white wire to "neutral" terminal, black wire to "live" terminal, green to ground terminal.

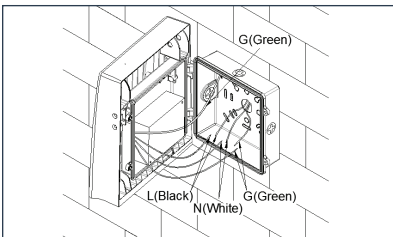

4. Close the fixture and tighten the screws.

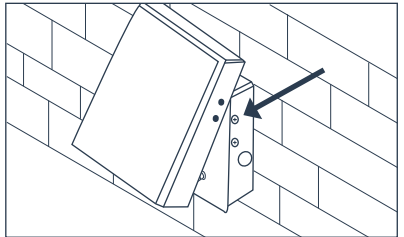

5. Adjust the fixture to a proper angle.

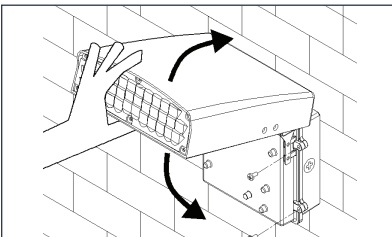

6. Loosen drain screw (bottom of fixture) until O-ring just clears contact with the box, and then tighten drain screw one full turn.

